



OFFICE

NEW OFFICE CONSTRUCTION / LANDMARK OFFICE PARK

PROPERTY HIGHLIGHTS

- » New construction with a modern design and professional image
- » Located in the rapidly growing Urban Loop office corridor
- » Immediate access to Interstate 35/80 at 86th Street and 100th Street
- » Ideal location for medical and professional services
- » Zoned for commercial office, flex, and service uses
- » Highly visible with building signage available
- » Parking Ratio: 5.7 per 1,000 SF

Distance from I35/I80 to Landmark Office Park

- 100th St Interchange - .58 miles
- 86th Street Interchange - .87 miles

AVAILABILITY & TERMS

- » Approximately 2,410 RSF
- » Lease Rate: \$15.25 per RSF NNN
- » Landlord TI Allowance: \$30 per RSF

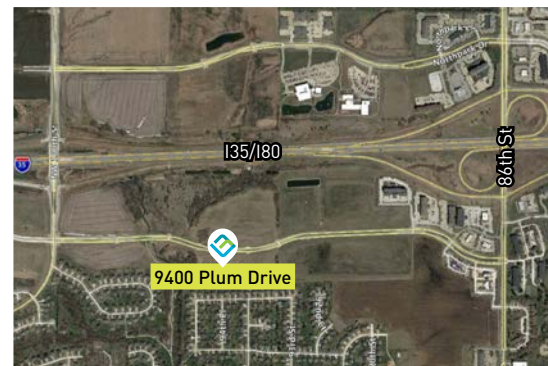

Information contained here deemed reliable but not guaranteed by Landmark Brokerage, Inc.

AVAILABLE SPACE

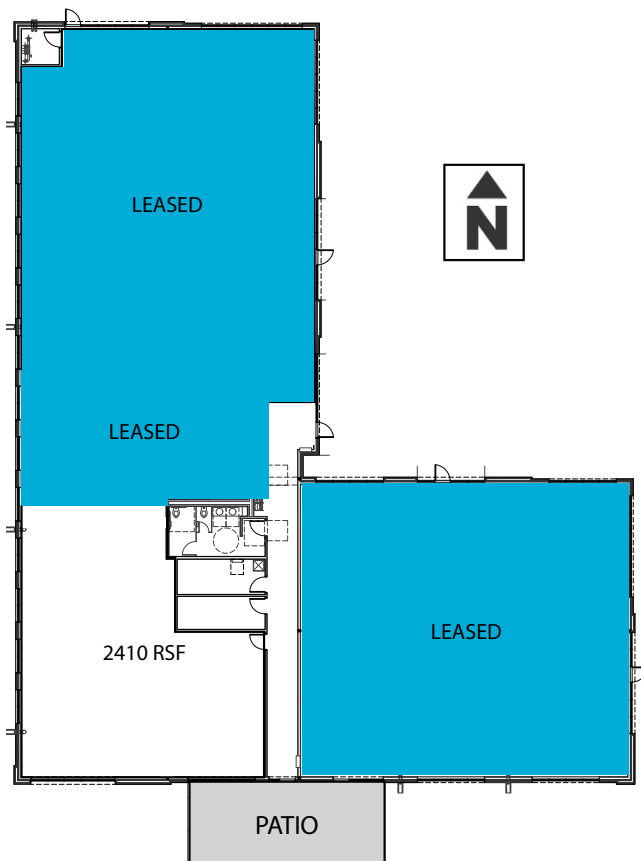

SITE PLAN

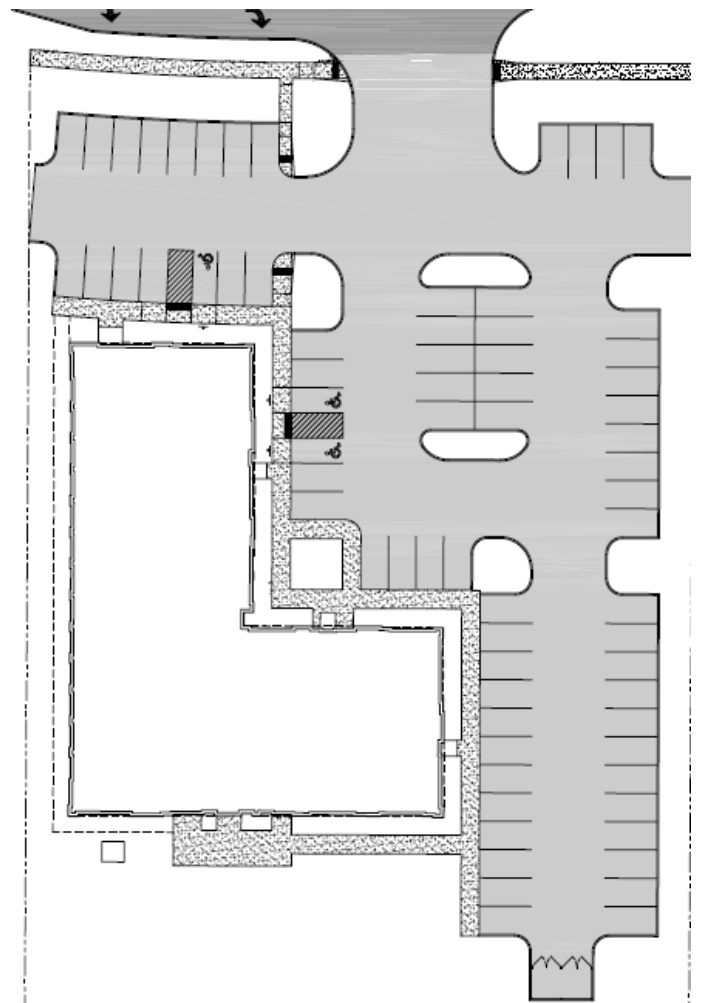

Information contained here deemed reliable but not guaranteed by Landmark Brokerage, Inc.











Information contained here deemed reliable but not guaranteed by Landmark Brokerage, Inc.

9550 Hickman Road // Suite 100
Clive, Iowa 50325

Mike Bonnett
P. 515.986.5994
C. 515.865.6086
E. mbonnett@lmcompanies-inc.com

lmcompanies-inc.com

	<u>3 miles</u>	<u>5 miles</u>
 Population	59,864	163,893
 Median Household Income	\$85,767	\$85,019
 Median Age	38.6	38.4
 Total Businesses	3,241	6,983
 Total Employees	44,510	104,135
 Owner Occupied Housing	69.4%	67.9%
 Median Net Worth	\$207,566	\$196,850
 College Graduate +	47.9%	49.6%

Source: ESRI 2020 Estimates



Map Data © 2020 Google Maps